

Providing you direct access to important insurance resources via your smartphone, tablet or computer

Key features:

- View policies
- Pay bills and view statements
- View active claims status¹
- Easily contact your agent and our claims department
- Access your vehicle ID cards²
- Get coverage information and direct-dial access to roadside assistance, identity theft assistance and travel assistance³
- Use the find my car tool⁴
- And much more!



Nationwide®
is on your side

Get started today!

Download tips

1. To access your account via a smartphone or tablet, simply go to your app store and type **Nationwide Private Client Connect** into the search box and download the app. If you are using an iPad, you may need to search “iPhone only” apps. To access via your computer, visit nationwide.com/privateclient and log in.
2. If you are a first-time user, you'll be asked to create an account and enter your policy number, date of birth and ZIP code (your policy number can be found on your policy declarations page).
3. Once registered, create your user name and password and begin to explore all the available features securely and conveniently at your fingertips 24/7.

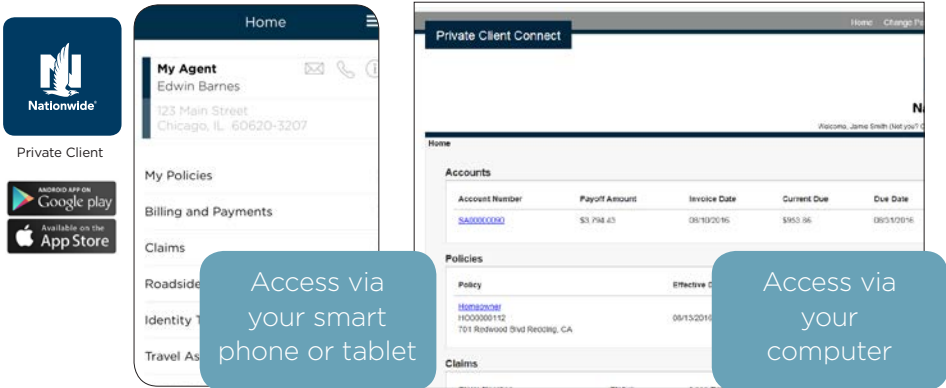

Registration tips

1. If you have a policy with Nationwide Private Client, click “create an account.”
2. Enter your policy number, date of birth, and ZIP code, then click “next.”
 - Policy number can be any product written with Nationwide Private Client (home, auto, collections or excess)
 - Date of birth must match the date of birth input on policy
 - ZIP code must be that of the residence address
3. Once registered, create a username and password.
4. Click the “yes” radio button, and then click “finish.”
5. Explore the available features, such as billing and payments, my policies, find my car and more.

WELCOME TO
Private Client Connect

Don't have an account? [Create an account](#)

Username

Password

Back Create Account

To verify your account please enter your policy number and answer the following security questions.

Your Policy Number

Policy Number

Your Birthdate

Your Zip Code

Next

Create Account

To complete registration, please enter a case-sensitive username and password.

Enter Your Desired Username

test

Enter A Password

Re-Enter Password

Yes I agree to [Privacy Statement](#) and [Terms and Conditions](#).

Finish

If you have registered for Private Client Connect on your computer, there is no need to register again on the app. Simply use the same username and password.

Call us with questions:

Private Client Solutions Center

1-855-473-6410 | Monday through Friday | 7 am—8 pm CT